

1 START

Resistor - Weerstand - Résistance - Widerstand - Resistencia - Modstand - Vastus - Resistenz

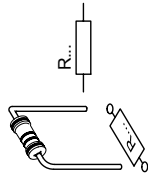

Solder side - Soldeerzijde - Côte de soudure - Lötseite - Lado de los soldadura



◇ R1 : 100

◇ R2 : 100K

(Brown, Black, Brown) - (Bruin, zwart, Bruin) - (Brun, noir, Brun) - (Braun, Schwarz, Braun) - (Brun, Svart, Brun) - (Ruskea, Musta, Ruskea) - (Marrón, Negro, Marrón) - (Castanho, Preto, Castanho) - (Marrone, Nero, Marrone)

(Brown, Black, Yellow) - (Bruin, zwart, Geel) - (Brun, noir, jaune) - (Braun, Schwarz, Gelb) - (Brun, Svart, Gul) - (Ruskea, Musta, Keltainen) - (Marrón, Negro, Amarillo) - (Castanho, Preto, Amarelo) - (Marrone, Nero, Giallo)

Component side - componentzijde - Côte composants - Bauteilseite - Lado de los componentes

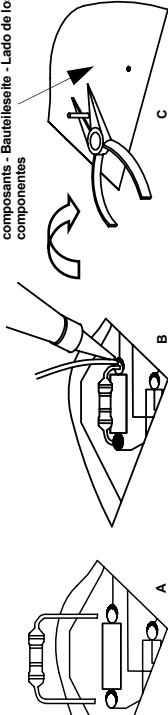

2 BATTERY HOLDER

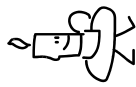
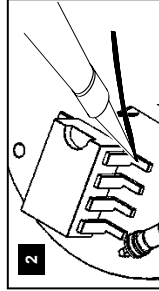
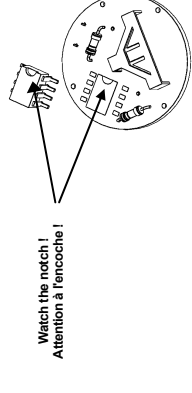

4 PCB TABS

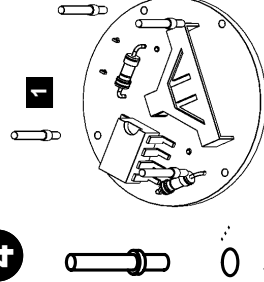

◇ 4 x

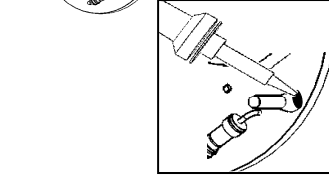

5 BUTTON

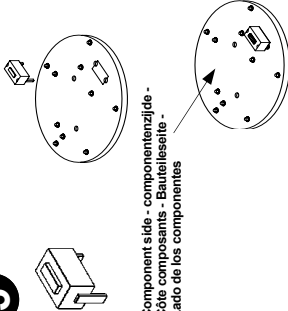

Component side - componentzijde - Côte composants - Bauteilseite - Lado de los componentes

6 LED

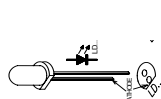

◇ 5mm Yellow

7 LED COVER

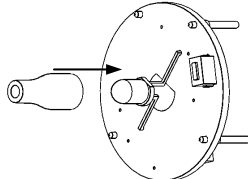

1

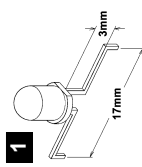

2

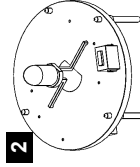

8 BATTERY

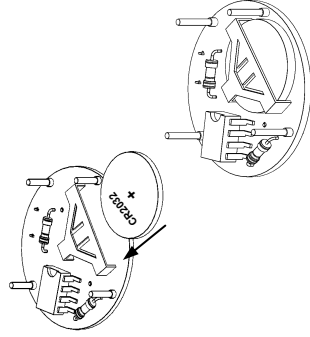

9 OPERATION

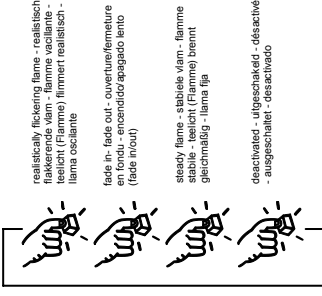

DIAGRAM

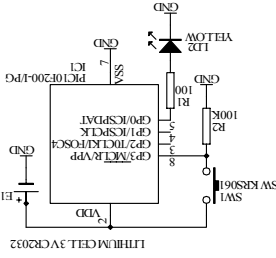

◇ IC1 : VMK167 (programmed P.C.10F200-UPG)